



Des pompes au process



PCM - DELASCO

Pma
Pma10

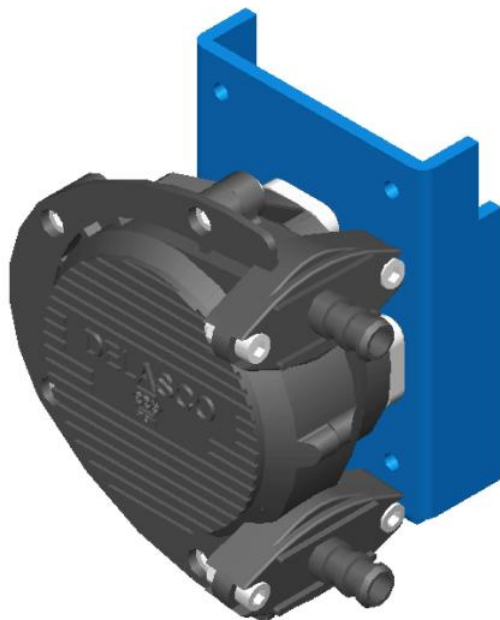

NIDEPMA03A

2005

2005



98/37/CE

98/79/CE,

EN ISO 12100.

Vanves, 10/01/2005

A handwritten signature in black ink, consisting of several overlapping loops and a long horizontal stroke extending to the right.



PCM.



PCM MOINEAU

PCM PRECI-POMPE

PCM MOINEAU OILFIELD

PCM DELASCO

PCM DOSYS

PCM

PCM

PCM



0.	1
0.1	1
0.2	2
1.	3
1.1	3
1.2	4
1.2.1	4
1.2.2	7
1.3.1	9
1.3.2	12
1.3.3	12
2.	14
2.1	14
2.1.1	14
2.1.2	14
2.2	14
2.2.1	14
2.2.2	14
2.2.3	15
2.3	15
2.4	15
3.	16
3.1	16
3.2 /	16
3.3	17
3.4	17
3.4.1	17
3.4.2	17
3.4.3	18
3.4.4	18



3.5.1	18
3.5.2	(. 3.1)	19
3.5.2.1	((511) (504)	19
3.5.2.2	(502)	19
3.5.2.3	(505)	20
3.5.2.4	(501)	20
3.5.2.5	(503)	20
3.5.2.6	20
3.5.2	(. 3.1)	20
3.5.3.1	(501)	20
3.5.3.2	(505)	21
3.5.3.3	(502)	21
3.5.3.4	(503)	21
3.5.3.5	21
3.5.3.6	(511)	21
	(504)	22
3.6	,	22
3.7	22
4.	23

PCM

()
()



0.

0.1 _____

a)

b)

: PMA10NR1S

PMA10;
N;
R;
1S;

:

4

c)

d)

e)



.1



0.2



3.2 3.3.

4: "

"")

PCM POMPES.

48

3

1.

1.1 _____

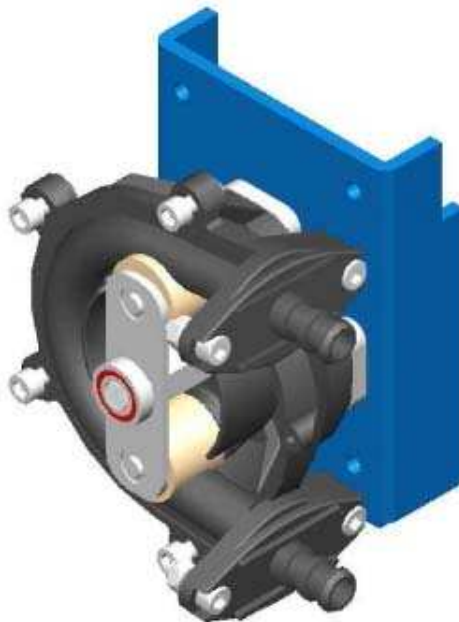
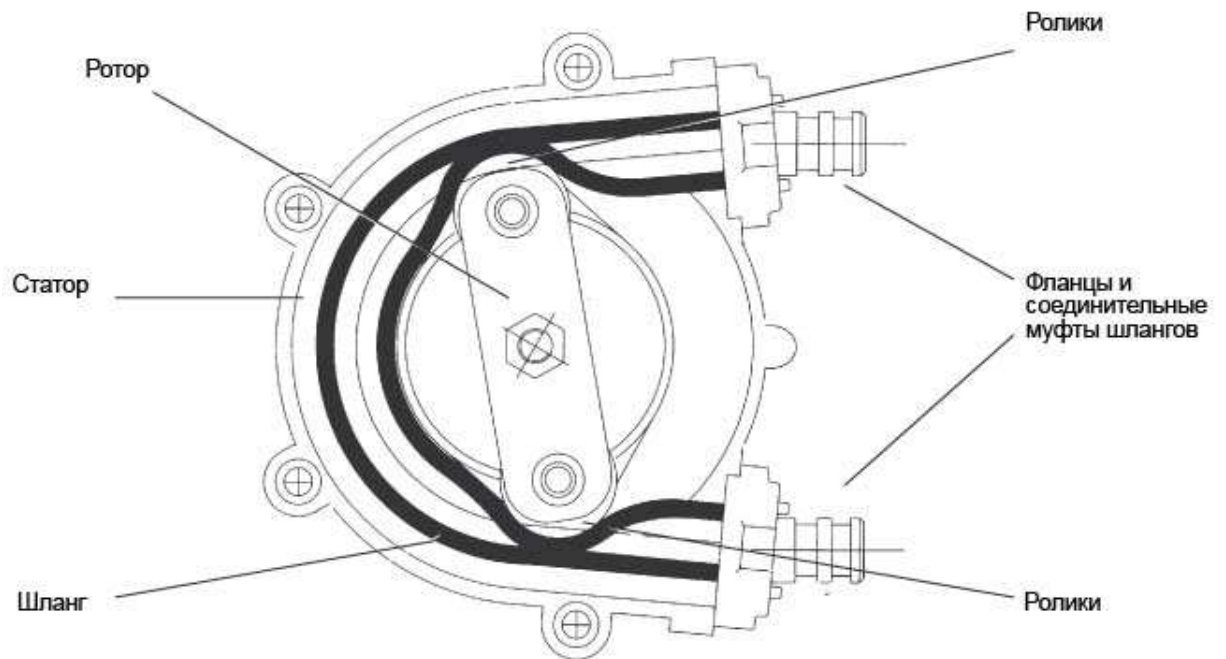



()

1.2 _____

1.2.1 _____

	Pma10
	CR
	X2CrNiMo17-12-2

	Pma10
	Ø15
	1/2- BSP B
	X2CrNiMo17-12-2

N.B.:

- Z2CND17.12 BSP B 1/2" NF E 03-005.
 - CR " "
 - ")
- PCM (1 4

НАСОС СО СВОБОДНЫМ КОНЦОМ ВАЛА

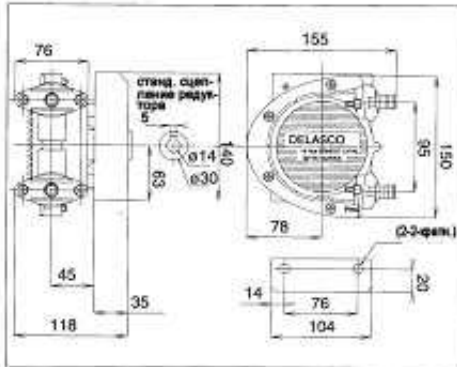

ВЫПУСКНЫЕ ОТВЕРСТИЯ

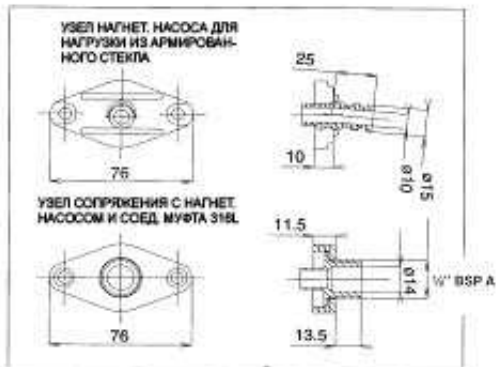

ЭЛЕКТРИЧЕСКИ ПРИВОДИМЫЙ В ДЕЙСТВИЕ НАСОС С РЕДУКТОРНЫМ ЭЛЕКТРОДВИГАТЕЛЕМ

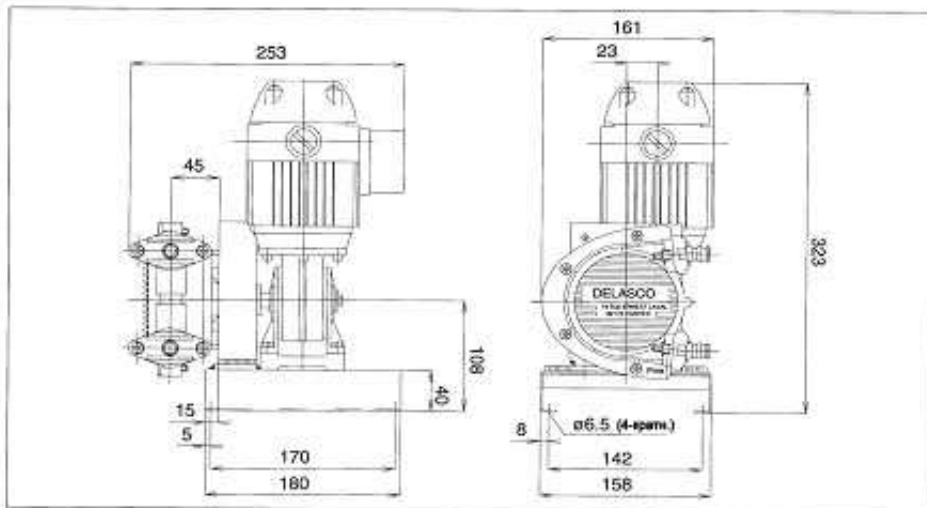

ЭЛЕКТРИЧЕСКИ ПРИВОДИМЫЙ В ДЕЙСТВИЕ НАСОС С ВАРИАТОРОМ СКОРОСТИ

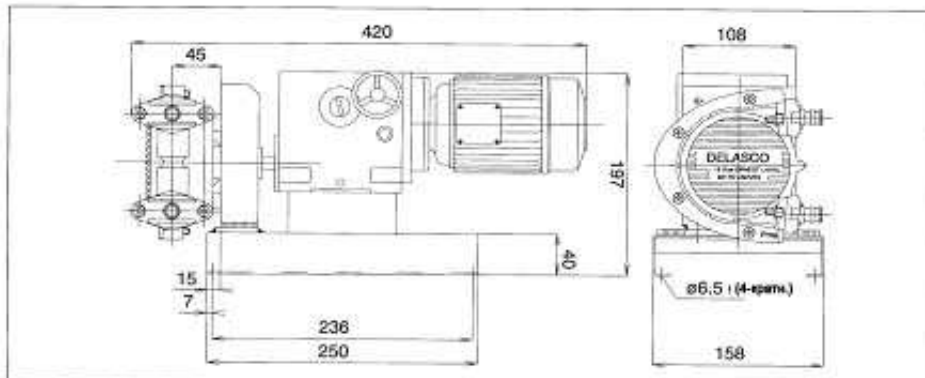



1.2.2



(. .) , , .

PCM DELASCO () 70 ().

	8	20	10
CR	5 70°C	90°C	100°C
	5 90°C	95°C	120°C
	5 90°C	95°C	120°C

- : 2.
- : 1/3
- : 25 – 60 %
- : 1800 () (.) .

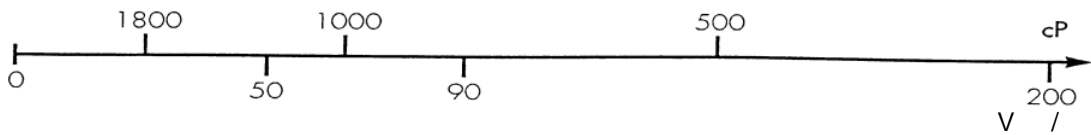

" / "

: _ : 20°C
 -
 -
 - CR 1 0



ПРОИЗВОДИТЕЛЬНОСТЬ в л/час

Вод. ст. (С.Е.) 3 м
Макс.

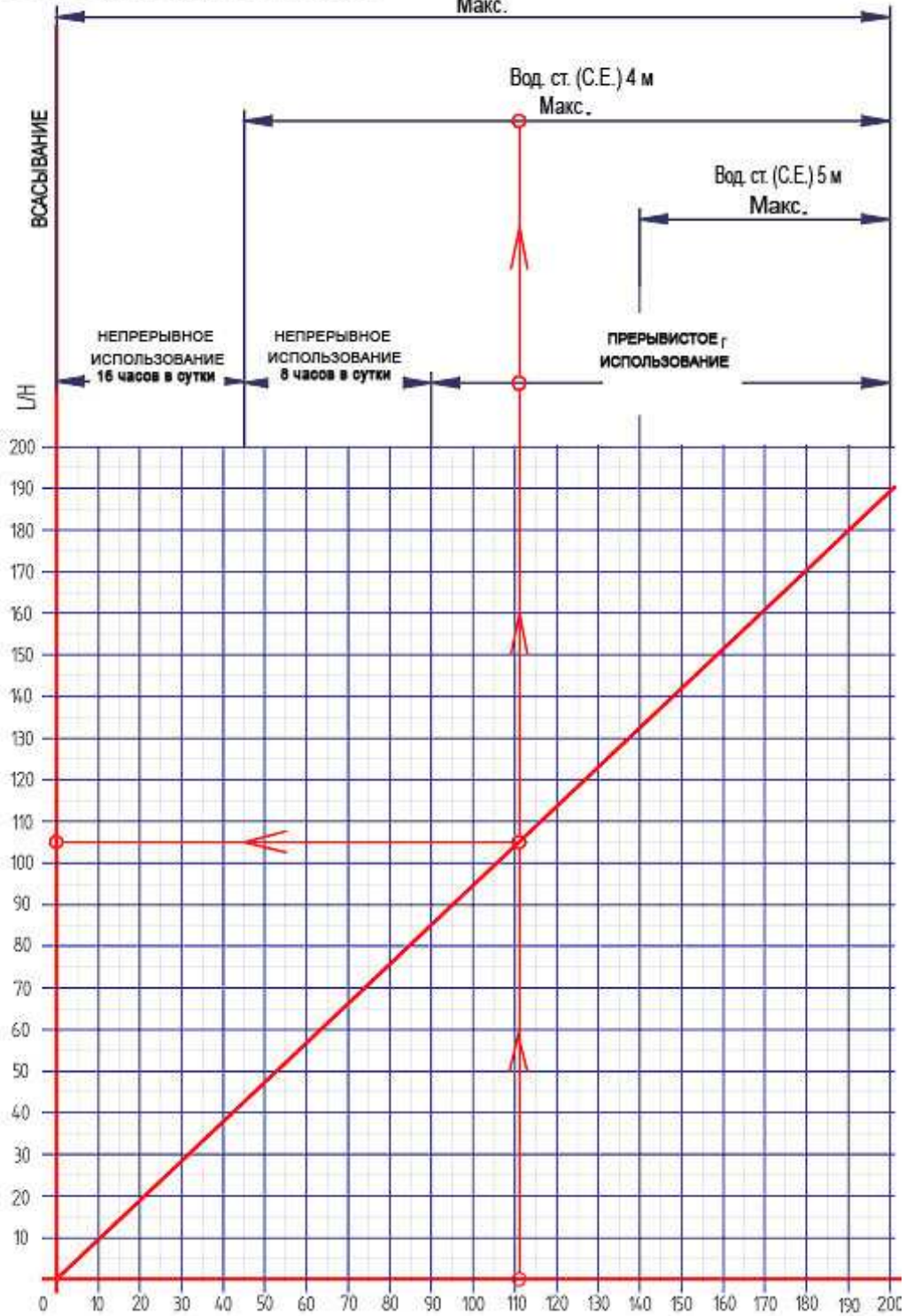

: 111 / .

105 / ,

PVA 10

).

(

.7



1.3



.1.3.1

-5°C

60°C.

. PCM

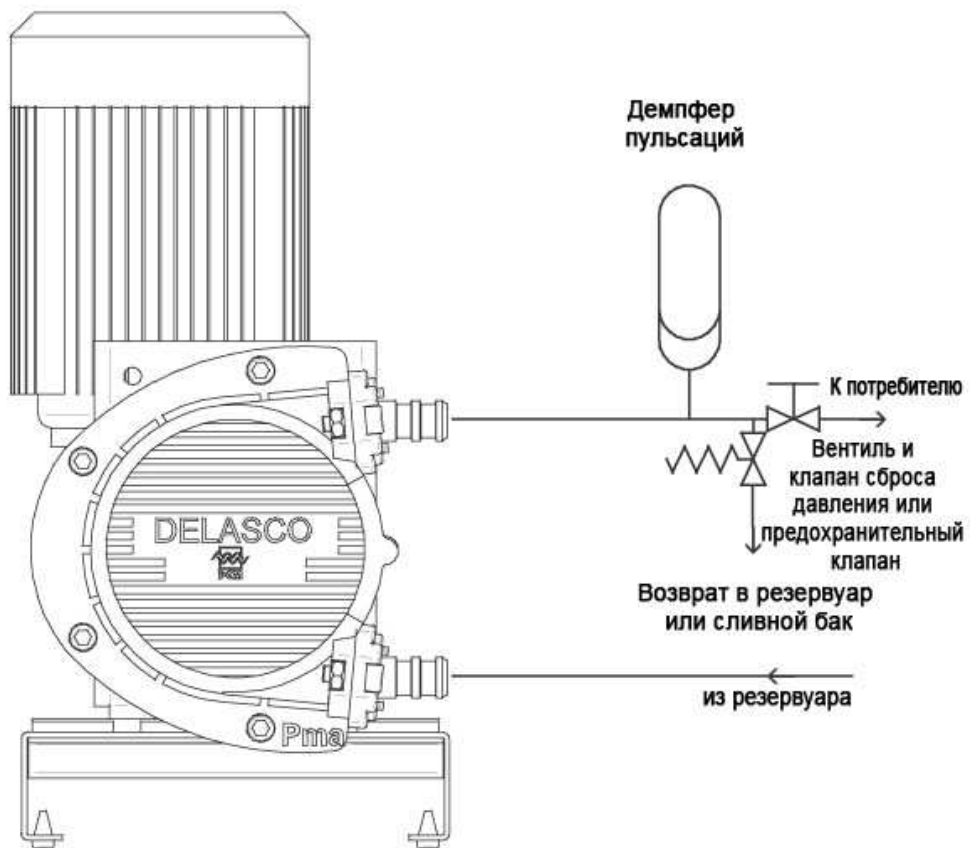



()

()

()

.1

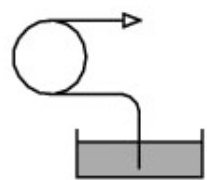

.1

N.B.:

.2.

3.

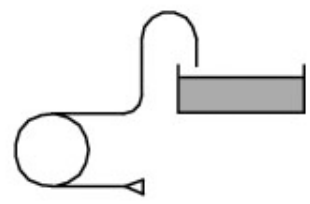

.2

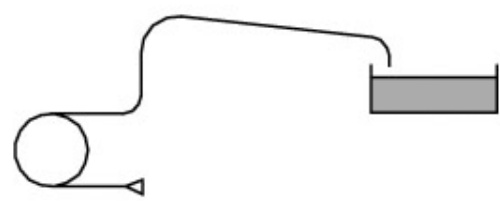

.3

.9

.4.

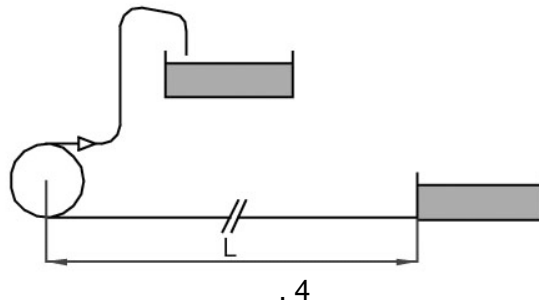

.5

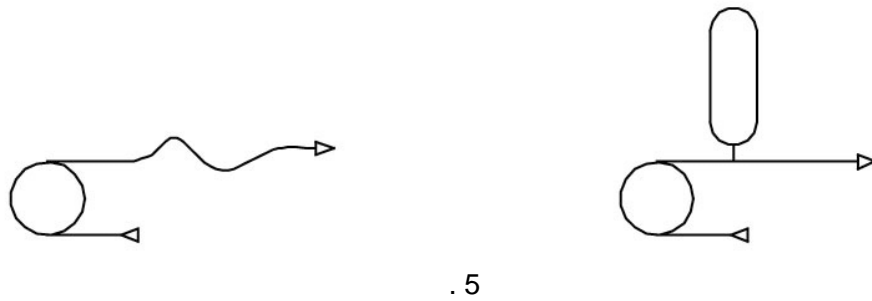

.6

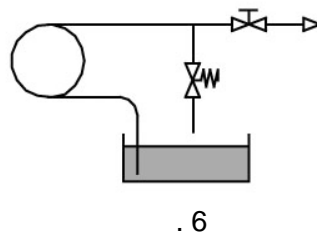

N.B.:

.7

90°. (C-).

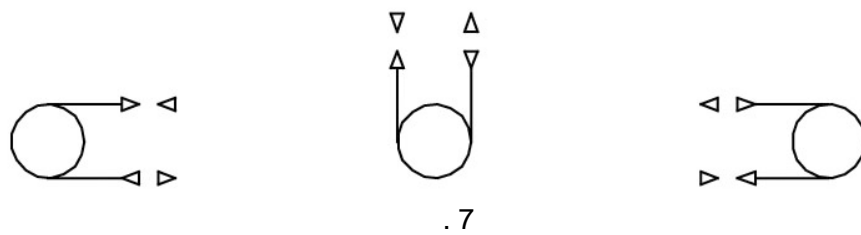

.10



N.B.:

-
-
- T- 2 Y-

1.3.2

	Pma10
	Ø15
	1/2- BSP B
	X2CrNiMo17-12-2

N.B.:

Z2CND17.12

BSP B 1/2"
BSP

NF E 03-005.

1.3.3



!

220

50

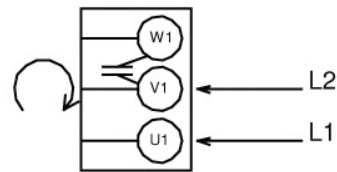
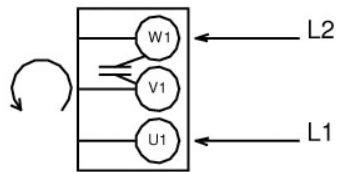

220 - 240

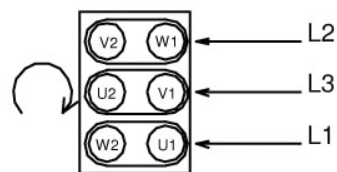
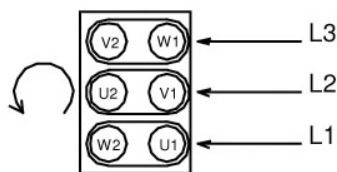

. 11



380 - 460

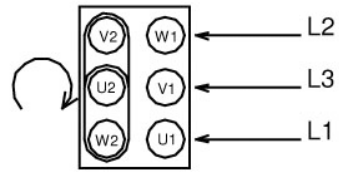
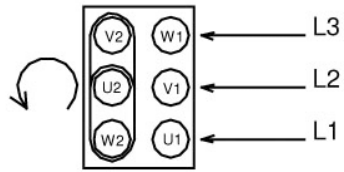

" ! "

(,) ()

(C-)



2.

2.1 _____

2.1.1 _____

— , :

— ,

— ,

—

2.1.2 _____

—

—

—

—

—

· ,

· ,

· ,

·

(4. " ")

PCM.

2.2 _____

2.2.1 _____

— p , :

— ,

—

2.2.2 _____

— ,

—



2.2.3 _____

4 "

"



!

2.3 _____

—
—
—
—
—
—
—
—
—
—

3.5: 3.5 "

(

"

.2.2.3,)

2.4 _____

3.

3.1

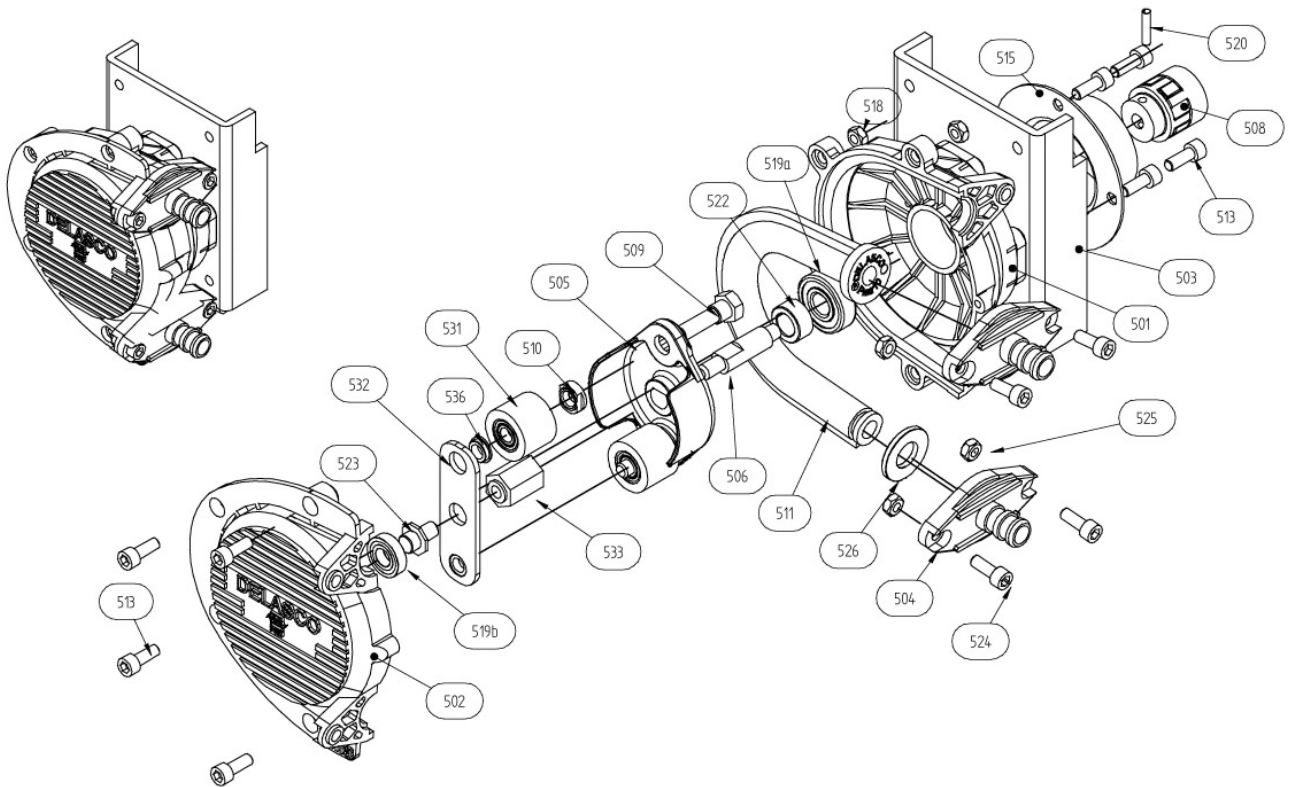



3.2 _____ /

3.3 _____

A) _____ PCM

B)

C) _____ S.E.I. 4c

3.4 _____

PCM



3.4.1 _____ (_____)

—
—
—
—



3.4.2 _____

. 2.2.3.

3.4.3 _____

. 3.5.2.1).

250-

Delasco,

(.

PCM 096200.000.

(

25).

3.4.4 _____

	-
	()
M6	5,6
M8	13,3

3.5 _____

3.5.1 _____





	a)	a)
	b)	b)
	c)	c) (),
	d)	d)
	e)	e) /
	f)	f)
	g)	g)
	h) (5)	h)
	a)	a)
	a)	a) - ,
	b) :	b) (. . 1.3).
	c)	c)
	d) /	d) /
	a)	a) / 90°
	b)	b)
	a)	a)



3.5.2 _____ (. _____ . 3.1)



3.5.2.1 _____ (511)

(504)

(504)

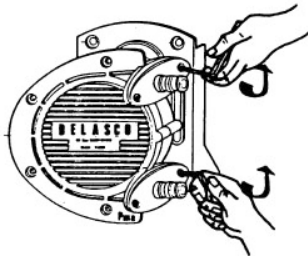

(526) (511). (504)

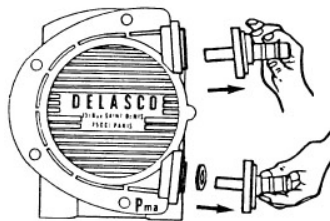

(511)

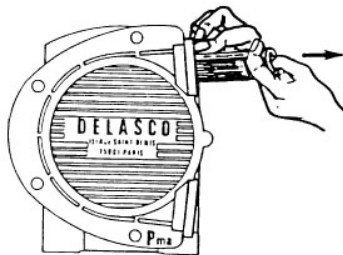

3.5.2.2 _____ (502)

(504) (511) . . .
3.5.2.1).

(502).



3.5.2.3 _____ (**505**)

- (504) (511) . . 3.5.2.1).
- (502) (. . 3.5.2.2).
- (523)
- (532).
- (536) (531).
- (533)
- (505),

- (510)
- (509) (505)

3.5.2.4 _____ (**501**)

- (505) (. . 3.5.2.3).
- (501) (503)
- (501) ()
506)
- (506) (507)..
- (519) ()
501).

3.5.2.5 _____ (**503**)

- (503)
- (501) ()
503).
- (503) (501)

3.5.2.6 _____

- ,
- ,
- ,

3.5.3 _____ (**3.1**)

3.5.3.1 _____ (**501**)

- (519) ()
501)
- (506) ()
508) (519).
- (501) (503)

(. 3.4.4).



3.5.3.2 _____ (**505**)

— (501) (. . 3.5.3.1).
— (509) (505)
(510)
(. 3.4.4).
— (506) (506).
— (533) (. 3.4.4).
— (531) (509).
— (532),
(536) (509).
— (532)
(517) (. 3.4.4). (523)

3.5.3.3 _____ (**502**)

— (501) (. . 3.5.3.1).
— (505) (. . 3.5.3.2).
— (501) (502) (. .
3.4.3).
— (501) (502)
— (. 3.4.4).

3.5.3.4 _____ (**503**)

— (503) (.
3.4.4).
— (. 3.4.4).

3.5.3.5 _____

—
—
 (503) .
— (. 3.4.4).



3.5.3.6 _____ (511)
_____ (504)
- _____ (511), _____ (. . 3.4.3)
_____ ()

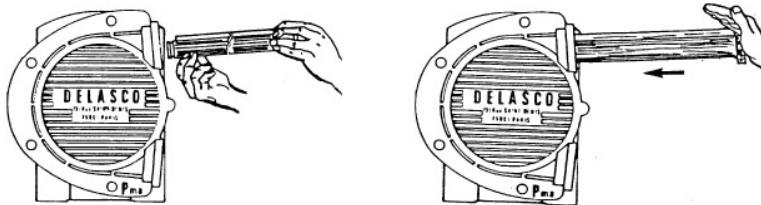

- _____ (, 526)
- _____ (504)
- _____ (504) . 3.4.4).
_____ (,



_____ (. . 3.4.3).

3.6 _____

_____ :
- _____ ,
- _____ ,
- _____ ,
- _____ ,
- _____ ,
- _____ ,
_____ :

3.7 _____

4: " "



- PCM (c . . .)
-
- ()
- ()



PCM		I121F/d (21/03/2006)
------------	--	-----------------------------

: 05/01/2000	: FAVREAU	: 1/1
:	I ()	
:	,	.

:

1	:	(-	,	,
:	,	,	...).	RAL:	20
:	:	:	:	:	:
					. PCM: 42911 902G

1	:	()
:	:	RAL:	20
:	:	:	:
			. PCM: 42911 902G

2	:		RAL: 5019	9010	35
:	:	:	:	:	. PCM: 42930 5019
			7	HY	9010.
HYA340	-				23°C: 5

